

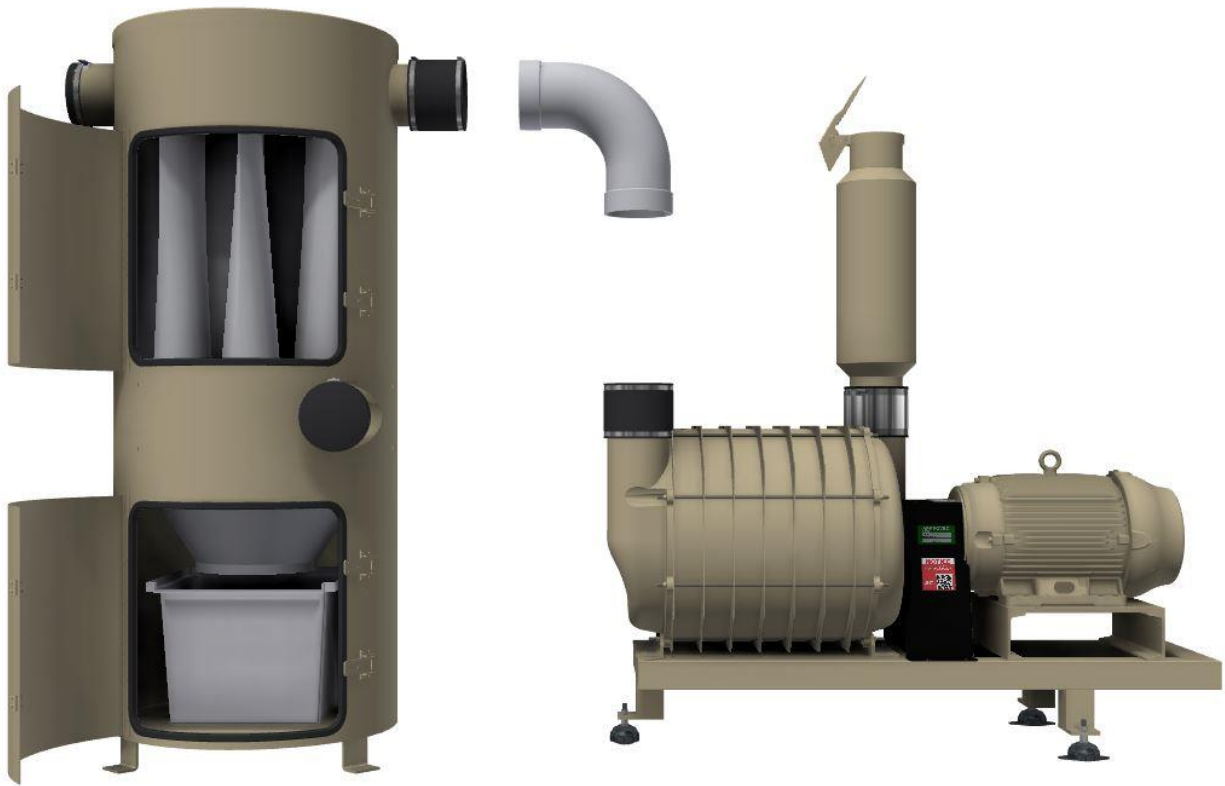

30HP Super Duty Vacuum System



Owner's Manual

Sonny's Enterprises, LLC.
5605 Hiatus Road
Tamarac, Florida 33321

Table of Contents

SAFETY REQUIREMENTS.....	3
INTRODUCTION	5
30HP Product Specifications.....	6
30HP Product Features	7
Optional Equipment	8
INSTALLATION	9
Utilities Requirements	9
Electric	9
Plumbing	10
Mechanical	11
Vacuum Installation Instructions.....	12
GENERAL OPERATION.....	21
PREVENTIVE MAINTENANCE	22
DAILY	22
WEEKLY MAINTENANCE	24
SEMI-ANNUALLY	27
ANNUALLY	27
Do’s and Don’t’s	28
VACUUM COMPONENTS	29
Installing A Water Separator To Your Vacuum System.....	29
Vacuum Filter Separator Tank.....	30
Turbine Replacement Program	31
WARRANTY.....	32
CONTACT US.....	33

SAFETY REQUIREMENTS

****WARNING****

- All employees must be thoroughly trained in safe operation and standard maintenance practices. All employees must review this entire manual monthly.
- Do not enter the wash tunnel when the equipment is operating. Death or dismemberment may occur.
- Do not wear loose fitting clothing or jewelry around moving equipment. Do not allow any part of your body or other objects (including ladders, hoses or tools) to come in contact with moving equipment. Entanglement may result causing death or dismemberment.
- Do not leave a ladder or any other items such as wash down hoses or tools in the wash tunnel while equipment is running. Vehicle damage and injury, including death, can occur.
- Always exercise caution when walking (never run) through the wash tunnel as there may be slippery conditions. Be careful so you do not bump into or trip over equipment.
- Only those employees specifically instructed and trained by the location management are permitted to enter the wash tunnel to perform inspections or maintenance. At least two qualified maintenance people must be present when performing equipment repairs or preventive maintenance.
- Do not perform any maintenance or work on equipment unless you first perform Lock-Out Safety Precautions. All electrically powered equipment must have manually operated disconnects capable of being locked in the "OFF" position. Equipment that has been "locked out" for any reason must be restarted only by the person who performed the "lock out" operation.
- When working on any equipment that is higher than your shoulders, always use a fiberglass ladder that is in good condition.
- Do not attempt to repair or adjust any pressurized liquid or pneumatic part, hose, pipe or fitting while that equipment is in operation.
- Electrical connections and repairs must be performed by a Licensed Electrician Only.
- Emergency "STOP" buttons must be well marked and their location and proper use reviewed with all personnel. Any activated "STOP" button must be reset only by the person who activated it. Clear the wash tunnel of any people, ladders, hoses, tools and other loose items before restarting the equipment. An audible device must sound to warn people that the equipment is starting.

- Do not operate any piece of equipment that requires safety covers with those covers removed or improperly installed. Do not operate any piece of equipment if any component of that piece is suspected to be defective or malfunctioning.
- Store all cleaning and washing solutions and oils in a well-ventilated area. Clean up fluid spills immediately to prevent hazardous safety conditions. Be certain to follow all safety procedures on SDS Sheets for each chemical product used.
- All hydraulic and electric systems in the wash tunnel equipped with a torque relief or overload should be checked and set at the minimum amount that will allow for proper functionality under normal washing conditions.
- No unauthorized people should ever be permitted in the wash tunnel or near the equipment at any time.

!! CAUTION !!

When a piece of equipment must be in operation during inspection or maintenance, one qualified technician must stay at the power disconnect switch while another qualified technician performs the inspection or maintenance.

INTRODUCTION

This Manual contains information that is vital to the successful installation, operation and maintenance of your Sonny's vehicle washing equipment.

Please read, and understand, the full contents of this manual before installation and operation of the equipment. Keep this booklet in a location where it may be used for ongoing reference.

Should you have any questions on the operation or servicing of this equipment please contact:

**TECHNICAL SERVICES DEPT.
SONNY'S ENTERPRISES INC.
5605 Hiatus Road
TAMARAC, FLORIDA 33321**

TELEPHONE: 800-327-8723 FAX: 800-495-4049

THANK YOU FOR YOUR CONFIDENCE IN SONNY'S!



30HP Product Specifications

- Capable of handling a **minimum of 12 vacuum hose drops**, up to a **maximum of 14 drops**
- Assembly total weight is **965 lbs**
- 9000 square inches of filter area through 10 bags
- 7 impellers.
- 6 inch standard inlet and outlet connections

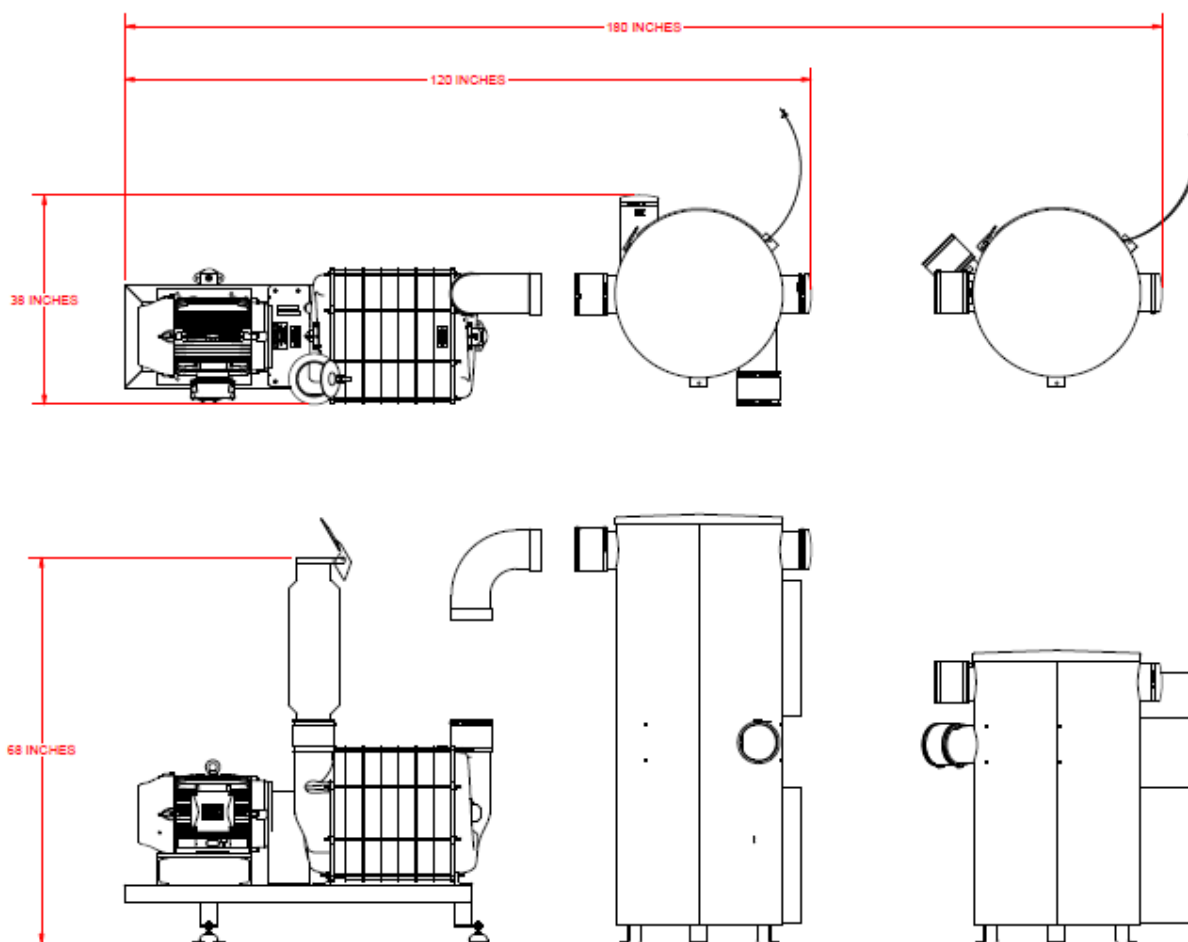

For parts and accessories information, please refer to our catalog or visit our website at SonnysDirect.com.

30HP Product Features

- Producer shaft bearings easily accessible for routine maintenance
- Snap-in filter bags have positive connections to the separator tank
- Filter bags will not mildew or rot
- Oversized dirt bucket is easy to remove, empty, and replace
- Electric motor and vacuum producer are direct coupled for efficient operation
- Shaft rotation arrows are part of the producer housing casting, not removable decals
- Precision factory impeller balancing and assembly assures efficient operation
- Stainless steel separator with adjustable latches and rubber gaskets for tight seal
- Wet separator tank available
- Silencer included - exhaust muffler helps reduce noise

Optional Equipment

Optional Water Separation Tank



It's like buying insurance for your central vacuum system. Ideal for snow or other wet conditions and underground piping. Keeps filter in driest condition and prevents bags from clogging.

Optional Turbine Lift Kit

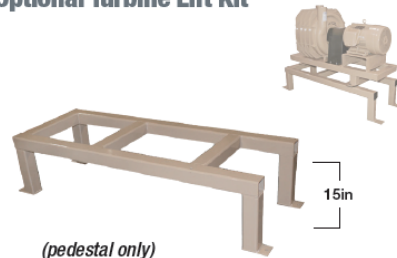

The Lift Kit raises the motor and turbine pedestal an additional 15in off the ground, ideal for areas with high water or snow.



Sonny's Cyclone Separator – creates a cyclonic effect which forces larger debris to the bottom of the separator, preventing clogged lines. Uses an easy twist and clean filter. Sonny's recommends using the Cyclone Separator in addition to the included standard debris separator.

Hose, Cuffs, and Claws



Connector Cuffs - thread onto the end of vacuum hoses, for easy attachment.

Claw Vacuum Tool – combines the utility of both a crevice tool and claw in one attachment, with no loss of suction.



Vacuum Booms - provide customers with an inviting free vacuum area that doesn't require a lot of staff, or effort, to keep ready to serve the next customer. The boom design keeps hoses securely off the ground providing better access to both sides of the vehicle and reducing wear and tear. Choose from different boom styles, canopy colors, drop kits, attachments, and piping.



INSTALLATION

Utilities Requirements

Utilities interconnection and the materials required for interconnection to Sonny's equipment are the responsibility of the customer.

Perform all trades work to all applicable local and national codes.

Electric

The Customer's Electrician is responsible for:

- Providing materials and installing single phase vacuum start-stop stations as required by the Customer that will provide power to the vacuum motor starter coil.
- Providing materials and installing single phase power through the Customer supplied Start/Stop stations to the vacuum motor starter coil.
- Properly sized interconnecting wiring from the 3-phase circuit breaker and motor starter to the 30HP, vacuum motor for 230V or 460V power source.
- The Customer's Electrician is to provide materials and install 3-phase power (230V or 460V) to the 30HP electric motor on the vacuum assembly through a properly sized 3-pole circuit breaker and motor starter with 3 thermal overloads. The use of copper wire is recommended. Earth grounding of the vacuum assembly is required.
- Overload protectors must be installed.

NOTE: Be certain the electric motor is properly wired for the supply voltage! Check motor name plate for voltage, phase and frequency before wiring. After wiring the motor, check for proper rotation as stamped on the vacuum producer end castings. Never operate the vacuum producer in the wrong direction.

Technical Disclaimer

- Although building codes have been considered in developing all drawings, verification of site-specific conditions and compliance with federal, state and local building codes is the exclusive responsibility of the customer and/or architect and engineer.

SPECIAL NOTE:

DO NOT USE WIRE NUTS TO CONNECT 3 PHASE WIRING AT THE ELECTRIC MOTOR TERMINAL BOX!!! ONLY USE SPLIT BOLT TYPE CONNECTORS WITH ELECTRICAL INSULATION TAPE AND RUBBER INSULATOR BOOTS!!!

Pictured is a split bolt connector available from Grainger.



Electrical Specifications – Vacuum Motor

30HP Electric Motor – 3600RPM

230V Amp Draw 68

460V Amp Draw 34

NOTE: Drawings below are for illustrative purposes only. Always wire to the instructions shown on equipment name plate.

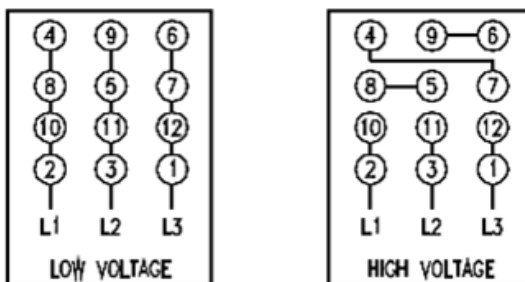

Plumbing

For the 30HP assembly the Customer's Plumber is responsible for providing materials and installing the following:

- Interconnect from the suction connection on the separator tank to the vacuum hose drop lines. All vacuum hose drop lines should use **6 inch diameter pipe size**.
- All piping turns should be with long sweep elbows NOT 90 degree elbows. Minimize the number of turns from the main line to the separator tank.
- All turn down piping from the main line to the vacuum hose drops should be with Tee's and the hose fitting connection point on the "T" should be 2 inch for each drop.
- Pipe between the Producer and Separator must be a **minimum 6 inch diameter pipe size**.
- Vacuum producer exhaust piping should go to atmosphere when the vacuum assembly is located in an enclosed area not subject to cool free airflow. If exhaust piping to atmosphere is required it should be **6 inch diameter** and heat resistant for at least the first ten feet. Exhaust piping must be weather protected at its exit point.

Mechanical

- Make sure there is adequate clear space around the vacuum assembly to allow free air flow and maintenance access. Do not locate the vacuum assembly in an area where customers may have direct access.
- For best results the 30HP vacuum assembly should be installed as close as possible to the vacuum hose drops.
- The exhaust muffler is to be installed with the connectors provided on the producer exhaust pipe located on the producer toward the electric motor.

Vacuum Installation Instructions

The turbine and the motor are independent of each other and are connected by a super-duty coupler.

1. First, inspect the vacuum producer for any damage during shipping and handling.
2. Attach the rubber vibration isolators to the bottom of the base. There should be one nut on the top of the floor plate, and two underneath on the threaded stud, as shown here:



3. Place the assembled frame in the area planned for final connections. For the 30HP assembly the inlet fitting from the vacuum hose drops should face the direction of the hose drops.



4. Using a $\frac{3}{4}$ " wrench, loosen the top nut on the three rubber feet. This will give you some room to adjust the frame, so that it is level.



5. To adjust the level of the frame, use a $\frac{3}{4}$ " wrench to turn and raise the top nut of the two under the frame, which will allow you to slightly adjust the level, as needed. The lower nut of the two under the frame should not be loosened.



6. Use a Level to check in 3 different planes on the frame, as shown below. Adjust the height by turning the three top nuts under the frame, as needed. Depending on how level your surface is, you may end up with a small gap (about $\frac{1}{2}$ " or so) between the two lower nuts, under the frame.



7. Once the unit is in place and leveled, tighten the three top nuts on the feet to 55 ft-lbs. to prevent the nuts from loosening during operation.



8. **Do not tighten** the nuts on the anchors for the isolators.



9. Remove the **Coupler Guard** from the frame.



10. Couplers have been pre-installed at the factory; **1-5/8in** Coupler for the Motor and **1-1/2in** for the Turbine.
11. Coupling Locking Collar should be loosely placed on the turbine shaft.
12. Alignment Procedure:
- Align the teeth on the two couplers with each other.



- b. Using the provided shims, check for axial and angular misalignment between the two shafts at every tooth of the coupler. The **0.060** shim combined with the **0.010** shim should be able to slide between each tooth pairing, but the **0.075** shim combined with the **0.010** should NOT be able to slide in. This will ensure the gap is within tolerance. (**0.070" - 0.085"**)

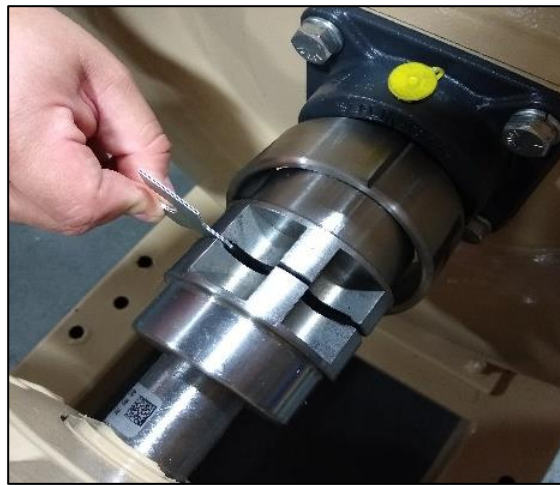

- c. Using a straight edge and feeler gauge, check for parallel misalignment in both the vertical direction and horizontal direction. To check vertical misalignment, place a straight edge on the flat spot across a tooth on the turbine side coupler (See picture below). Using feeler gauge, measure gap between straight edge and flat spot on corresponding motor coupler tooth as shown below.



- d. The above procedure for parallel misalignment **MUST** be repeated to check for horizontal misalignment.



- e. To ensure proper alignment, feeler gauge that fits in the gap created by the straight edge should be less than **0.010"** thick.
- f. If vacuum producer does not pass the above checks for misalignment. It **MUST** be aligned prior to starting up the vacuum turbine.
- g. To adjust alignment, loosen the 4 bolts at the motor base.



- i. For parallel misalignment in the **vertical** direction: Add / Remove shims under the motor base.
 - ii. For parallel misalignment in the **horizontal** direction: Shift the motor slightly using a rubber mallet.
 - iii. For **angular** misalignment: Add / Remove shims from only the front two holes, or back two holes, depending on which direction motor must be tilted.
- h. Once properly aligned, tighten motor base bolts to **57 ft-lbs**.
 - i. Check alignment again using steps **b** through **e**.
13. Make electrical connections to the motor (must be performed by a licensed electrician). Turn vacuum ON and OFF to create a short cycle of operation. Check for motor rotation during this test cycle. Motor rotation **MUST** match as shown by the arrow on the turbine housing. If the motor is initially running in the wrong direction, it **MUST** be corrected by a licensed electrician.

14. Coupler Locking Collar Installation

Once alignment has been confirmed to be within tolerances, proceed with installing the red flexible coupler insert (included).

- Wrap the provided red flexible insert around the couplers. Ensure it fully closes the loop around the couplers. (Part # 10013337)
- Groove on the flexible coupler insert should point **away** from rotation of turbine, as shown below. Turbine rotation is marked on the housing.

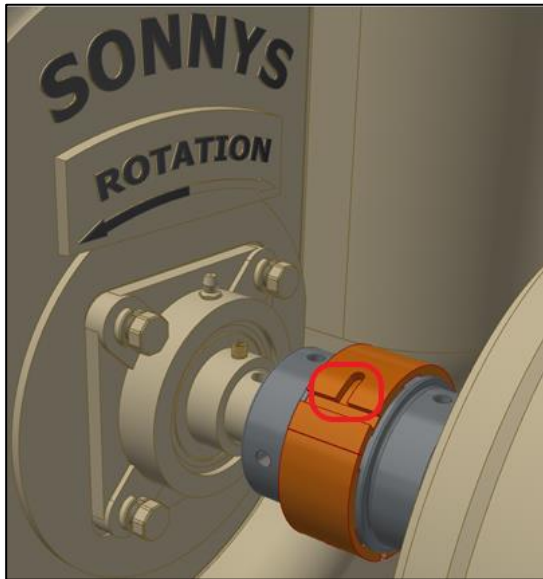

- c. Slide Coupler Locking Collar over flexible insert. Ensure the pins inside locking collar line up with the grooves on the flexible insert.



- d. Rotate Locking Collar opposite to turbine rotation as shown below, making sure the pins on the collar slide onto the grooves of the flexible insert. This step is critical to make sure cover and insert do not fall off.

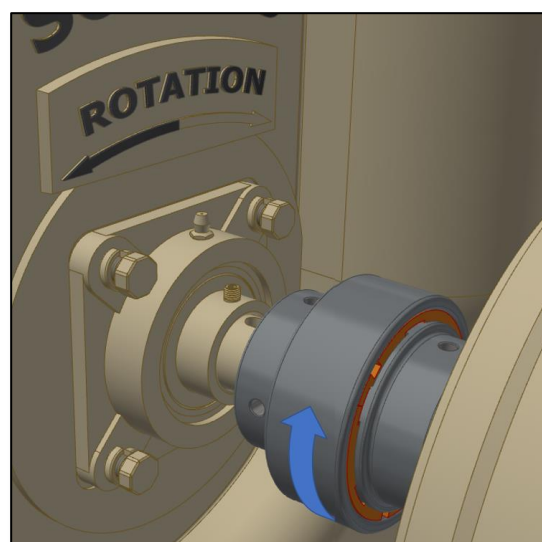

15. Re-install **Coupler Guard** on to the Vacuum Frame.



16. DO NOT grease bearings during initial Start-Up procedures. The bearings come pre-greased from manufacturer.

17. Turn on Vacuum Turbine and run for 1 hour to reach operating temperature. Turn off producer and check alignment again.

GENERAL OPERATION

- When the Start/Stop control is activated the producer motor starts and reaches full speed in approximately 3 seconds.
- When the producer motor is at full speed all vacuum hose drops may be used.
- De-activating the Start/Stop control will stop the producer motor and cause vacuum operation to cease.
- Before beginning daily operation be certain that the dirt canister is empty.
- Double check that the dirt canister door and the filter bag access door are firmly secured before starting the vacuum.
- If air leaks are heard around the vacuum assembly when the vacuum reaches full speed, turn the vacuum off and adjust the dirt canister door and filter bag access door for proper fit against the rubber seals.
- Continuous vacuuming of wet substances without the optional wet separator tank may cause permanent damage to the vacuum filter bags, impellers, and electric motor. **NEVER WASH THE FILTER BAGS !!!**
- Unused vacuum hose drops must be firmly closed off at the vacuum tool mouth in order that in-use vacuum hose drops operate efficiently.
- Do not operate the vacuum with the dirt canister door or the filter bag access door open or not firmly sealed and closed !!!

PREVENTIVE MAINTENANCE

FOR THE FIRST MONTH OF OPERATION CHECK ALL HARDWARE AND FITTINGS FOR TIGHTNESS EACH WEEK!

DAILY

Empty collected trash from the dirt canister.

- Turn power off to the vacuum. Open the latches for the **dirt canister access door** (bottom door).
- Remove and empty the dirt canister. Clean the compartment around the canister. Replace the empty canister in the storage compartment against the alignment flange.
- Check the black rubber seal around the door. Check for any cracks, leaks or tears in the seal. If the seal is damaged, a replacement can be ordered.
- Close the access door. Press the center of the door before fastening the latches to assure a proper door gasket seal.
- Turn on the vacuum. Listen for any leaks around the door gasket. Re-seal if necessary.
- Clean the mesh filter located inside the separator. Do not remove the filter. Instead, wipe the filter down from inside the upper access door, where the filter bags are located.



Clean the filter bags.

- Turn power off to the vacuum. Open the latches for the **filter bags access door** (top door).
- Manually shake the filter bags behind the upper door on the separator tank.
- **Inspect filter bags** for any damage, tearing or wetness, replacing damaged bags.
- **Inspect filter bags for proper seating.** If a bag is not properly seated, it may pop out of place, leading to dirt clogging the system. It is therefore extremely important to ensure that the filter bags are correctly seated in place. Details for replacing a filter bag are on the following page.



Example of an un-seated filter bag.

- Close the access door. Press the center of the door before fastening the latches to assure a proper door gasket seal.
- Turn on the vacuum. Listen for any leaks around the door gasket. Re-seal if necessary.
- Inspect vacuum hoses and tools for cuts, excessive wear, or trash blockage. Replace as necessary.
- Turn the vacuum on and check all hose drops for proper operation.

WEEKLY MAINTENANCE

- Inspect all filter bags for wetness or tears. Replace as necessary.
- **To replace a filter bag**, hold the ring at the bottom of the bag, then tuck the bag material down into the ring.



- With the bag material tucked inside, bend and fold the ring into a horseshoe shape, as shown below.



- Hold the ring between thumb and forefinger and place it inside of the bag opening.



- Release the ring into its natural round shape. You should hear it click in place, inside of the opening.
- Once snapped in place, the ring should fit tight inside of the opening. Test by pulling up on the bag. The bag should remain tightly attached inside of the hole when you pull up on it.
- Wrap the Velcro straps located on the top of the bag around the bar on the inside top of the vacuum separator.



WEEKLY MAINTENANCE (Continued)

- Check vacuum piping for pinhole leaks, cracks, or loose fittings.
- Inspect dirt canister and filter access door gaskets for cuts, excessive wear, or leaks. Replace as necessary.
- Clean the separator tank and producer housings.
- Grease impeller shaft bearings weekly. For each bearing, use **one pump of grease only (Mobil Polyrex EP2 – Part #10012823)**. This will provide the recommended grease to the bearings without over greasing them. **DO NOT OVER GREASE!** (**Note:** A temperature rise after lubrication, sometimes 30°F (17°C), is normal. Bearings should operate at temperatures less than 200°F (94°C) and should not exceed 250° (121°C) for intermittent operation.)



- Inspect the motor for damage or corrosion.

MONTHLY

1. Inspect all hardware for tightness.
2. Inspect Atra-flex coupler set screws for tightness.
3. Inspect Atra-flex plastic element for damage. Replace as needed.

Note: Do not tighten the nut that is attached to the anchors. The nut should be loose or taken off.

SEMI-ANNUALLY

For Older Motors:

1. **Lubrication:** Re-lubricate the 2 motor bearings by removing the seal plate then cleaning and refilling the bearing and bracket cavity with the recommended grease. Sonny's recommends **Mobil Polyrex EM (Part #40012549)** grease for the motor ball bearings.

Replace one pipe plug on each motor end bracket with a grease fitting. Remove the other plug for grease relief. Be sure fittings are clean and free from dirt. Using a low pressure grease gun, pump in **1-2 pumps of grease** until new grease appears at the grease relief hole. After re-lubricating, allow motor to run for 10 minutes before replacing pipe plugs in end bracket.

For New Motors:

2. All new motors come with permanently lubricated bearings that do not require greasing.

ANNUALLY

1. Have an electrician inspect the amperage draw from the motor.

Do's and Don't's

DO

- Check motor rotation direction before connecting the coupler whenever motor wiring is worked on
- Use minimum 6-inch diameter pipe between Producer and Separator
- Make sure Producer is level during installation
- Clean Separator filters daily
- Grease turbine bearings weekly

DON'T

- Tighten producer to the floor (nuts should not be tightened on floor anchors)
- Run the producer without checking motor rotation direction
- Run the producer with the coupler guard removed
- Run vacuum system with damaged filter bags
- Wash the filter bags with water
- Over-grease turbine bearings

VACUUM COMPONENTS

There are **7** diffuser plates in the 30HP VAC (they protrude from the turbine).

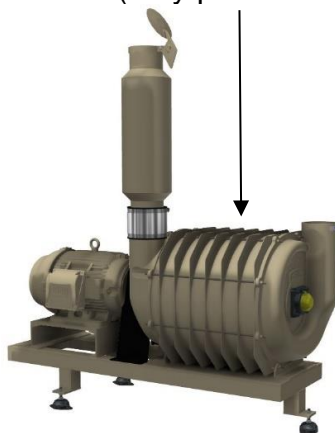

Installing A Water Separator To Your Vacuum System

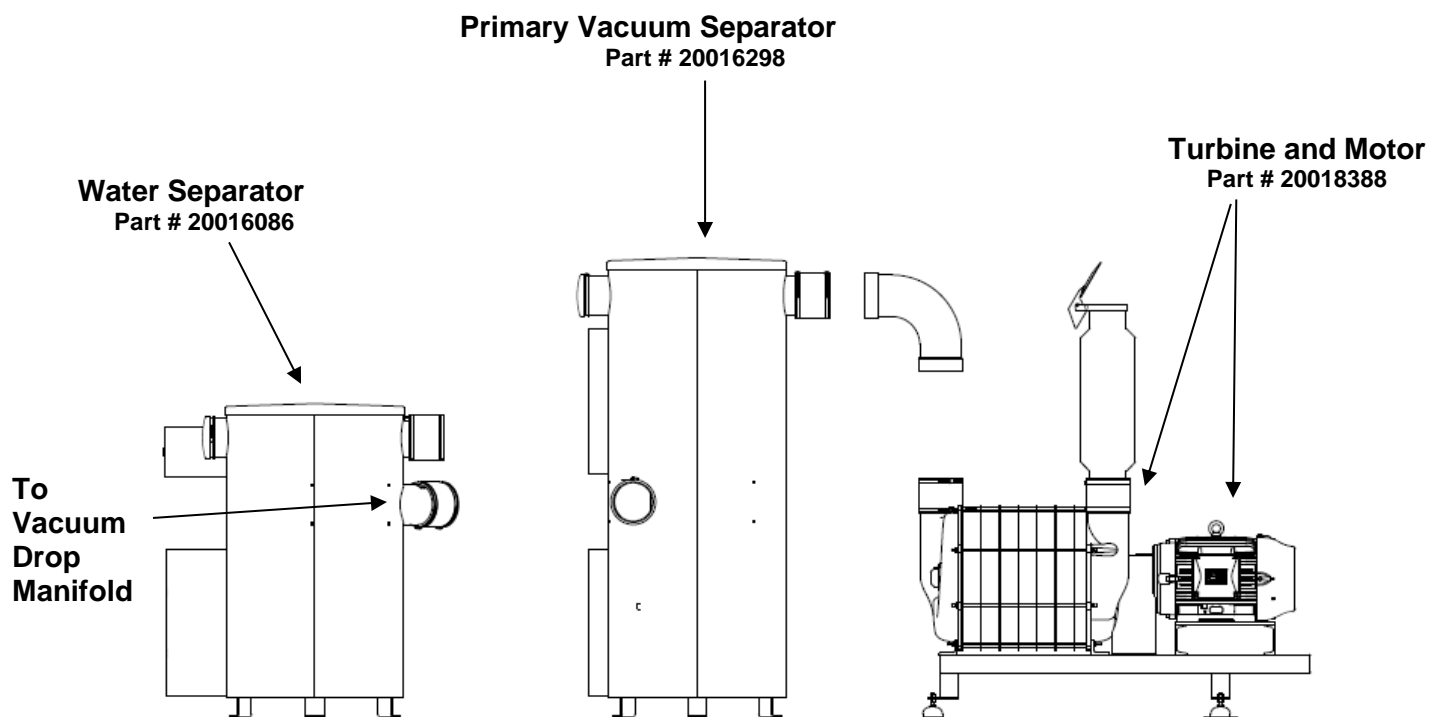

When using the stainless steel **Water Separator**, it is installed inline between the **Primary Vacuum Separator** and the **Vacuum Drop Manifold**.

Vacuum Filter Separator Tank

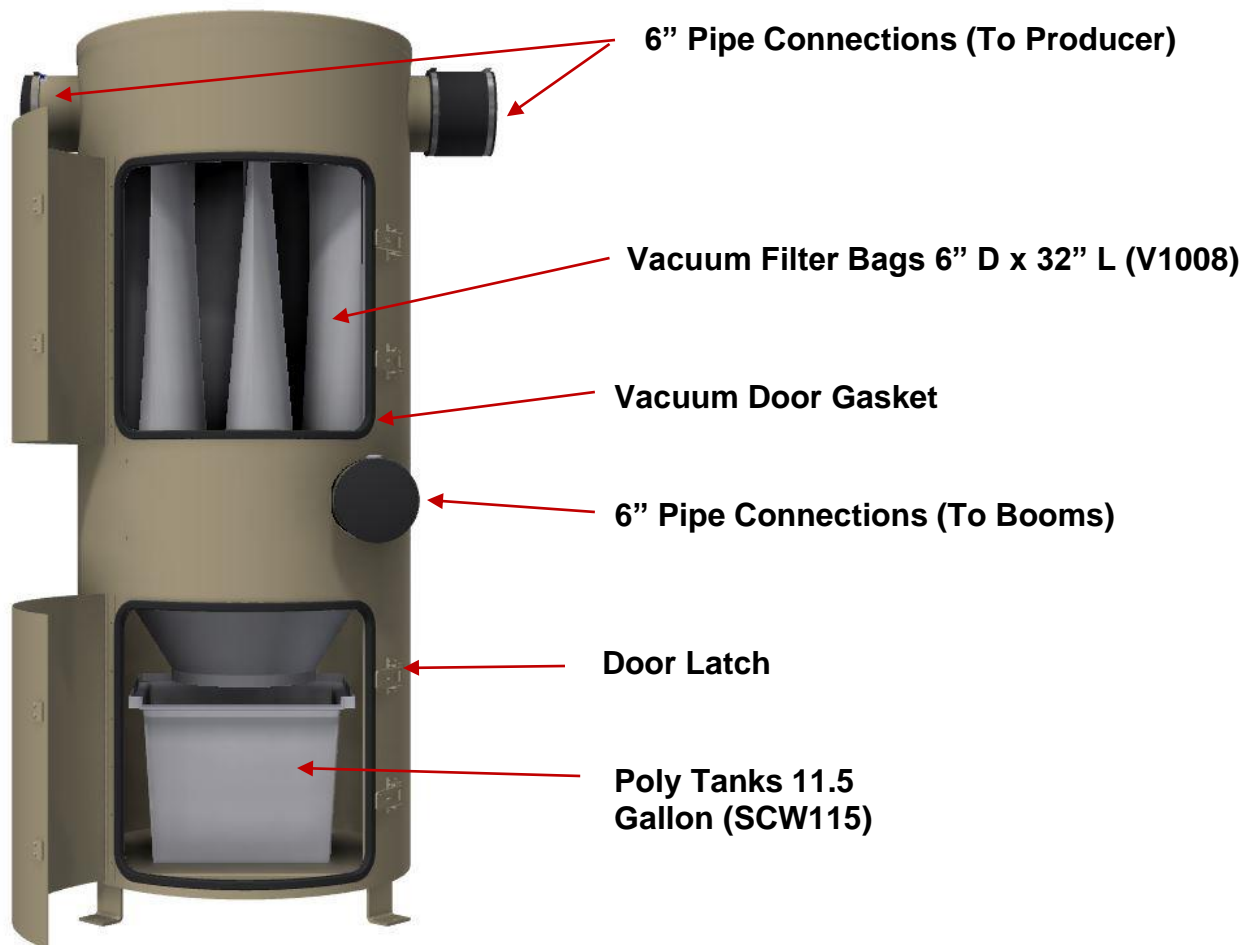

Turbine Replacement Program

Can't live without your Vacuum? Of course not!

Sonny's **Turbine Replacement Program** keeps you running, and it's quick & easy!

- Disconnect and reinstall your turbine only once
- Reduce downtime – no waiting for repair

How does it work?

We will send you a factory reconditioned turbine that matches your existing turbine's horsepower. Turbines are in stock and ready to go.

When you order the replacement turbine, you will receive a credit for the value of your old turbine and this credit will be issued towards the replacement charge.

- You do not need to return the old turbine; it can be disposed of.
- All freight charges are the responsibility of the customer.

Contact **Sonny's Customer Service** at **1-800-327-8723 x 200** or visit **SonnysDirect.com** for more information.

WARRANTY

SONNY'S ENTERPRISES, INC. FACTORY LIMITED LIFETIME WARRANTY

Equipment manufactured by SONNY'S ENTERPRISES, INC. is warranted to be free from defect in material and workmanship. Welded metal framework and other non-moving, non-wearable fabricated metal components manufactured by Sonny's are warranted for the life of the equipment to the original purchaser. Fabricated metal wearable surface and moving components manufactured by Sonny's are warranted for a period of one (1) year to the original purchaser of the equipment.

All components assembled to Sonny's equipment that are manufactured by others are warranted by the appropriate manufacturer and subject to that manufacturer's limited warranty. Contact Sonny's for the specific information on other component manufacturer's warranty terms. All new cloth shipped with new Sonny's equipment is warranted for a period of one (1) year or 80,000, whichever occurs first.

This warranty is not assignable or transferable. The warranty period begins the first day following installation or 30 days from the original invoice date, whichever occurs first. The Seller's liability shall be limited to repair or replacement of materials found to be defective within the warranty period. In the event of repair or replacement this limited warranty is noncumulative. The Purchaser must supply the Seller with immediate written notice when any defects are found. The Seller shall have the option of requiring the return of defective material to establish the Purchaser's claim. Neither labor nor transportation charges are included in this warranty. Transportation damage claims are to be submitted to the carrier of the damaged materials.

This warranty is based upon the Purchaser's reasonable care and maintenance of the warranted equipment. It does not apply to any equipment which has been subject to misuse, including neglect, accident or exposure to harsh chemicals or chemicals that react violently with: water, organic acids (e.g. acetic acid), inorganic acids (e.g. hydrofluoric acid), oxidizing agents (e.g. peroxides), and metals (e.g. aluminum). Chemicals corrosive to: aluminum alloys, carbon steel, and other metals. Nor does it apply to any equipment which has been repaired or altered by anyone not so authorized by Sonny's. Further, the equipment must be properly installed with proper accuracy of all specified plumbing, electrical, and mechanical requirements. This warranty does not apply to normal wear and tear or routine maintenance components.

EXCEPT AS EXPRESSLY STATED HEREIN, SONNY'S SHALL NOT BE LIABLE FOR DAMAGES OF ANY KIND IN CONNECTION WITH THE PURCHASE, MAINTENANCE, OR USE OF THIS EQUIPMENT INCLUDING LOSS OF PROFITS AND ALL CLAIMS FOR CONSEQUENTIAL DAMAGES. THE LIMITED WARRANTY EXPRESSED HEREIN IS IN LIEU OF ALL OTHER WARRANTIES EXPRESSED OR IMPLIED. SONNY'S NEITHER ASSUMES NOR AUTHORIZES ANY PERSON TO ASSUME FOR IT ANY OTHER OBLIGATION OR LIABILITY IN CONNECTION HERewith.

This document is confidential and proprietary to SONNY'S and cannot be used, disclosed or duplicated without prior written consent. Content, prices and availability subject to change without notice.

CONTACT US

SONNY'S ENTERPRISES, INC.

Business Hours

Office: Monday – Friday 8:00 AM – 5:30 PM ET**Customer Service:** Monday – Friday 8:00 AM – 8:00 PM ET

FOR TECHNICAL SUPPORT:

Phone: 1-800-327-8723 EXT 234**Email:** SONNYS-SUPPORT@SONNYSDIRECT.COM**24/7 EMERGENCY SUPPORT AVAILABLE**

FOR PARTS:

Phone: 1-800-327-8723 EXT 200**Email:** CUSTOMERSERVICE@SONNYSDIRECT.COM

FOR EQUIPMENT SALES:

Phone: 1-800-327-8723 Option 3**Email:** SALES@SONNYSDIRECT.COM