

JETPAC SERIES VACS

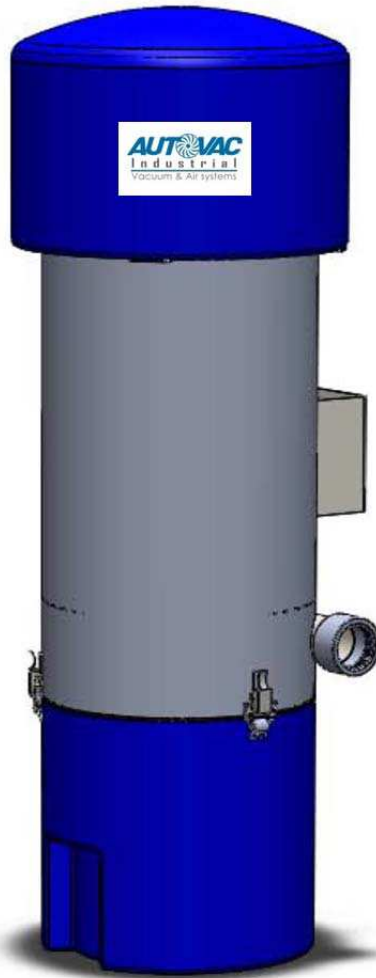

TABLE OF CONTENTS

- Product Information 3
- Specifications 4
- Installation
 - Requirements5
 - Vac Installation 6
 - Footprint and Dimensions 7
- Timer Setup
 - SSAC Setup 8
 - Timer Settings Chart 9
- Maintenance 10
- Parts Breakdown 11



Product Information

Please take a minute to fill out the information below in order to aid us with any future sales or service inquiries. Model number and serial number info can be found on the serial tag located under the top cover. If you have purchased a lockable enclosure you will find keys inside the control box and/or on the lower exterior of the can. Key number can be found on the tag that comes attached to the keys. There may be more than one key number depending on the unit.

Please keep this information with your records

Model #: _____

Serial #: _____

Key Number(s): _____
"If applicable"

Date Purchased: _____

Distributor: _____

AVI Car Care

297 Kingsbury Grade, Ste. 1019

Mailbox 4470

Stateline, Nev. 89449

(Not a shipping address)

Sales @ autovacinc.com

Specifications

120V Model

- Height: 48-1/4" • Weight: 75 lbs. • Canister Diameter: 14" • Dome Diameter: 17"

- Vacuum:

1 Motor Unit:

120 VAC., 50/60 HZ, 20 Amp Dedicated Service Req'd,

2 Motor Unit:

120 VAC., 50/60 HZ, 30 Amp Dedicated Service Req'd,

3 Motor Unit:

120 VAC., 50/60 HZ, 50 Amp Dedicated Service Req'd,

220V MODEL

- Height: 48-1/4" • Weight: 75 lbs. • Canister Diameter: 14" • Dome Diameter: 17"

- Vacuum: 1 Motor Unit

220 VAC., 50/60 HZ, 10 Amp Dedicated Service Req'd,

2 Motor Unit

220 VAC., 50/60 HZ, 20 Amp Dedicated Service Req'd,

3 Motor Unit:

220 VAC., 50/60 HZ, 30 Amp Dedicated Service Req'd,

- Motors: Electro Motor Universal Type, 50/60 HZ, 17,500 – 22,500 RPM

2 Stage Peripheral Bypass Discharge

UL Recognized Category

PRGY2(E13 6 622)

CSA Certified, Class 1611 01(LR31393)

Installation Instructions

To ensure proper functionality and adherence to both local and national electric codes, it is recommended that service be installed by a licensed electrician experienced in commercial applications. Inadequate power and wiring may cause the unit to perform erratically.

General Mechanical:

- All dimensions in drawings are in inches.
- Mounting stud size 3/8 x 16 UNC X 1"
- 4" minimum concrete required for mounting stud.
- 18" minimum pad recommended for bumper clearance

Electrical Service:

• 1 Motor Vac

-120V Vacs:

20 AMP dedicated service required. 12 awg. minimum wire gauge required (50 ft. run or less)

Wire size will vary with the distance from the service panel to the unit.

-220 Vacs:

10 AMP dedicated service required. 14 awg minimum wire gauge required (50 ft. run or less).

Wire size will vary with the distance from the service panel to the unit.

• 2 Motor Vac

-120V Vacs:

30 AMP dedicated service required. 10 awg. minimum wire gauge required (50 ft. run or less)

Wire size will vary with the distance from the service panel to the unit.

-220 Vacs:

20 AMP dedicated service required. 12 awg minimum wire gauge required (50 ft. run or less).

Wire size will vary with the distance from the service panel to the unit.

- **3 Motor Vac**

- 120V Vacs:

- 30 AMP dedicated service required. 10 awg. minimum wire gauge required (50 ft run or less)

- Wire size will vary with distance from the service panel to the unit.

- 220V Vacs:

- 30 AMP dedicated service required. 10 awg. minimum wire gauge required (50 ft run or less)

- Wire size will vary with distance from the service panel to the unit.

CAUTION

“Vacuum suction to unit cannot be blocked while vacuum is not in use but still running. Use a nozzle system that does not restrict airflow. Motor burnout will occur when using a vacuum restricting hangar or nozzle and will void warranty”

For Wall or Post Mounting

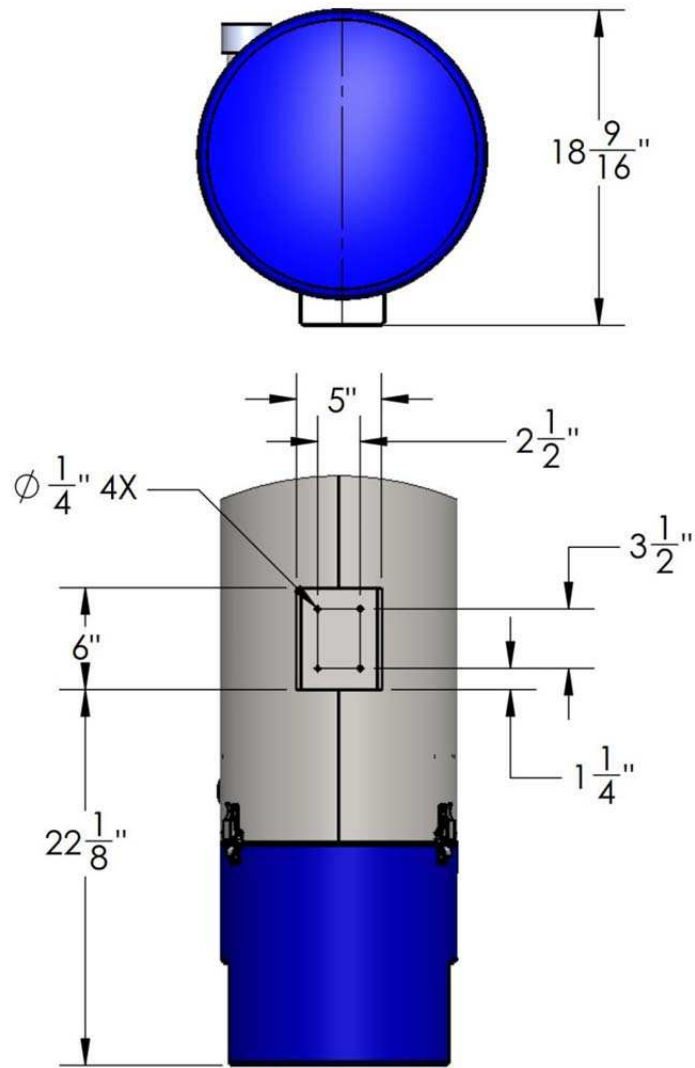

MOUNTING DIMENSIONS

Timer Setup – SSAC Timers

Note: “AE and “AN” model SSAC timers are accumulating timers. During use, timing can be extended proportionally by adding more coins. The SSAC timer has two settings: Time per coin (minutes) and number of coins to start.

Time per coin:

Timer per coin is the amount of time the unit will run per coin inserted and can be set from 0.1 minute (6 seconds) to 12.7 minutes (12 minutes and 42 seconds) in increments of 6 seconds by turning on the correct switches until their values equal the desired time. For custom settings, follow the steps below:

1. Figure the total time your Vac will run (in minutes) and divide that number by the number of coins to start. This is your time per coin. Round up or down to the nearest tenth of a minute.
2. Subtract the largest value switch (initially 6.4) from your time per coin.
 - a. If the resulting number is zero, move the switch to the “on” position and set all remaining un-set in the “off” position. Your timer is now set.
 - b. If the resulting number is zero, move the switch into the “on” position. Using the resulting number as your new time per coin, repeat step 2 with the next largest switch value.
 - c. If the resulting number is negative, set the switch in the “off” position and repeat step 2 using the next largest switch value.

Coins to start:

Coins to start is the amount of coins needed to activate the timer and can be set from one to seven coins in increments of one coin.

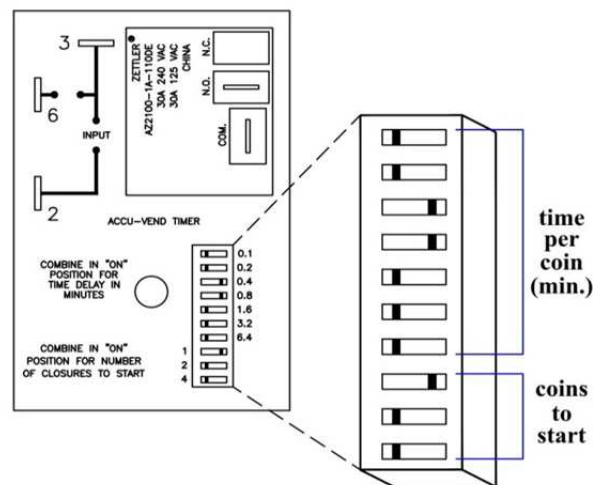
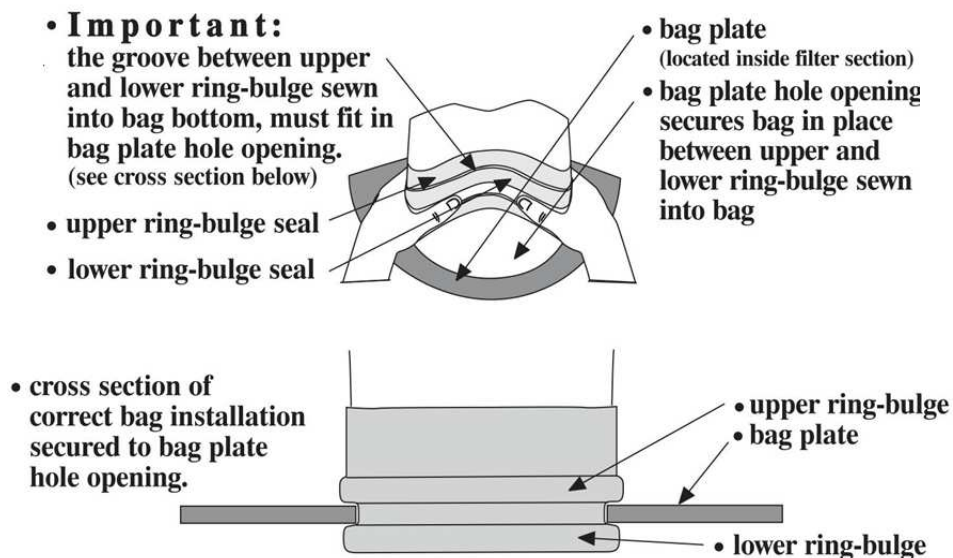
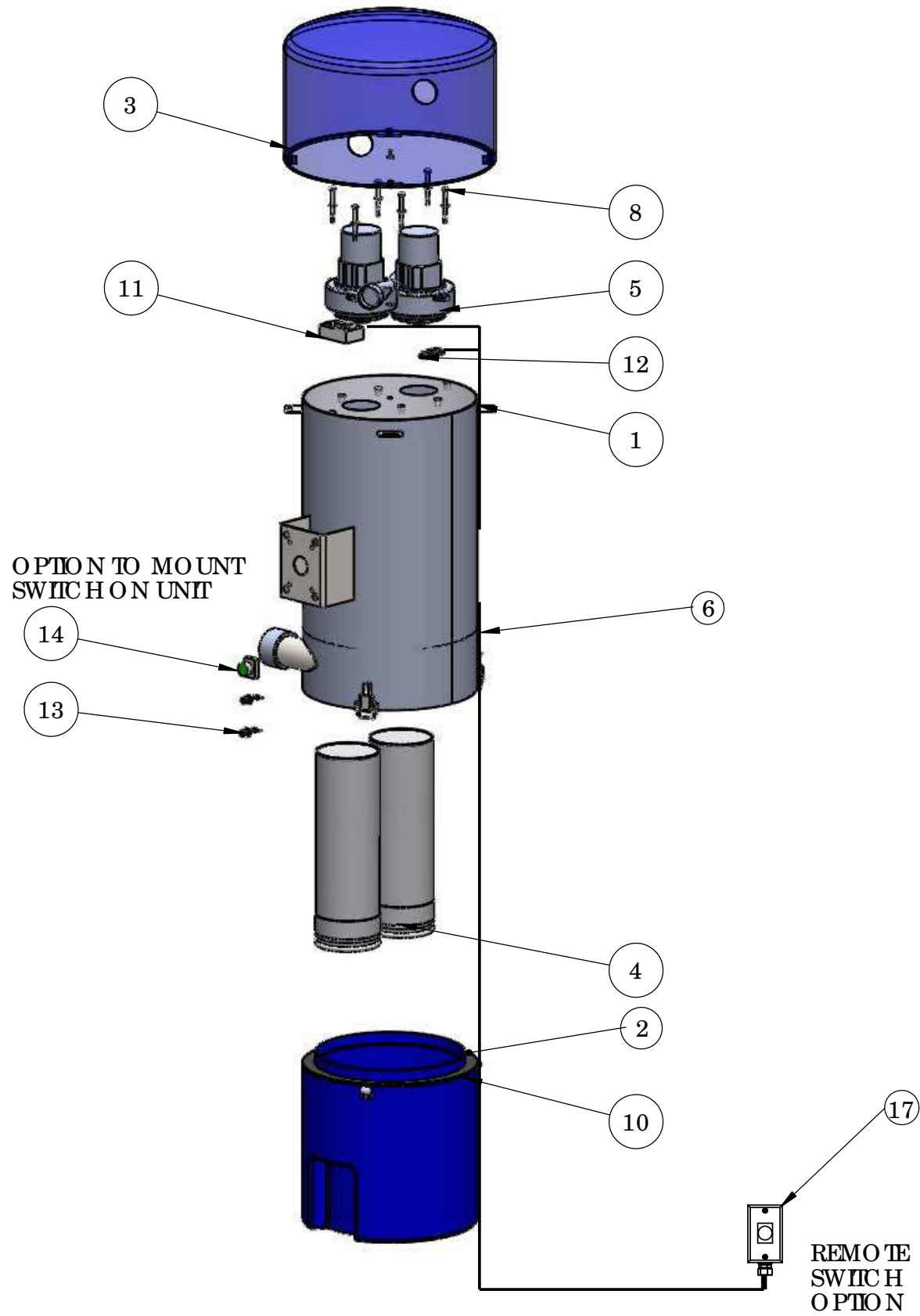

Figure 3 shows a SSAC Timer Set for 1 coin to start and 3.8 minutes per coin for a total run of 3.8 minutes per coin for a total of run time of 3.8 minutes (3 minutes and 48 seconds)

Maintenance

- Shake the dirt from the Filter Bags weekly. If possible, machine wash bags monthly. Hang bags until dry. DO NOT machine dry bags.
- Remove dirt and debris from the canister as required.
- Check motor gaskets periodically for signs of wear or damage and replace them as needed.
- Check vacuum hose and nozzle periodically for signs of wear or damage and replace them as needed.
- Clean the outside portion of the canister with a stainless steel polish. DO NOT use any abrasive cleaners, steel wool or any kind of to clean the exterior. Doing so could possibly scratch or damage the finish of the canister.
- Mild soap and water may be used to clean the decals. DO NOT use any harsh or abrasive cleaners or the decal surface maybe damaged.





ITEM NO.	PARTNUMBER	DESCRIPTION	QTY.
1	C010-0010-1	JETPAC VAC BODY	1
2	C911-4022	GASKET, FO RM RUBBER	1
3	C640-####	JETPAC VAC DOME COVER ASSY	1
4	C811-3001	VACUUM BAG , JETPAK	2
5	C640-1004	MO TOR, HIGH SPEED 11 AMP	2
6	C640-0010-1-9	PAN, HO USING FILIER	1
7	C911-0727	BO LT, HHC S, 1/4-20 X 0.5	4
8	C911-0717	BO LT, HHC S 1/4-20 X 2.75	6
9	C911-0704	WASHER, LO CK, SPLIT, 1-4 INCH	6
10	C740-1951-3	ARC H PRIMARY SEPARA TOR BUC KET ASSY BLUE	1
11	C690-0012	SSAC TIMER	1
12	C912-0065	TERMINAL BLO CK 4 POS.	1
13	C912-1105	FUSE HO LDER	2
14	C912-1106	FUSE 15 AMP	2
15	C912-0050	SWIIC H, PUSH BUTI ON	1
16	C912-0052	SWIIC H, C ONTACT	1
17	C499-001	JUNC TION BO X ASSY	1

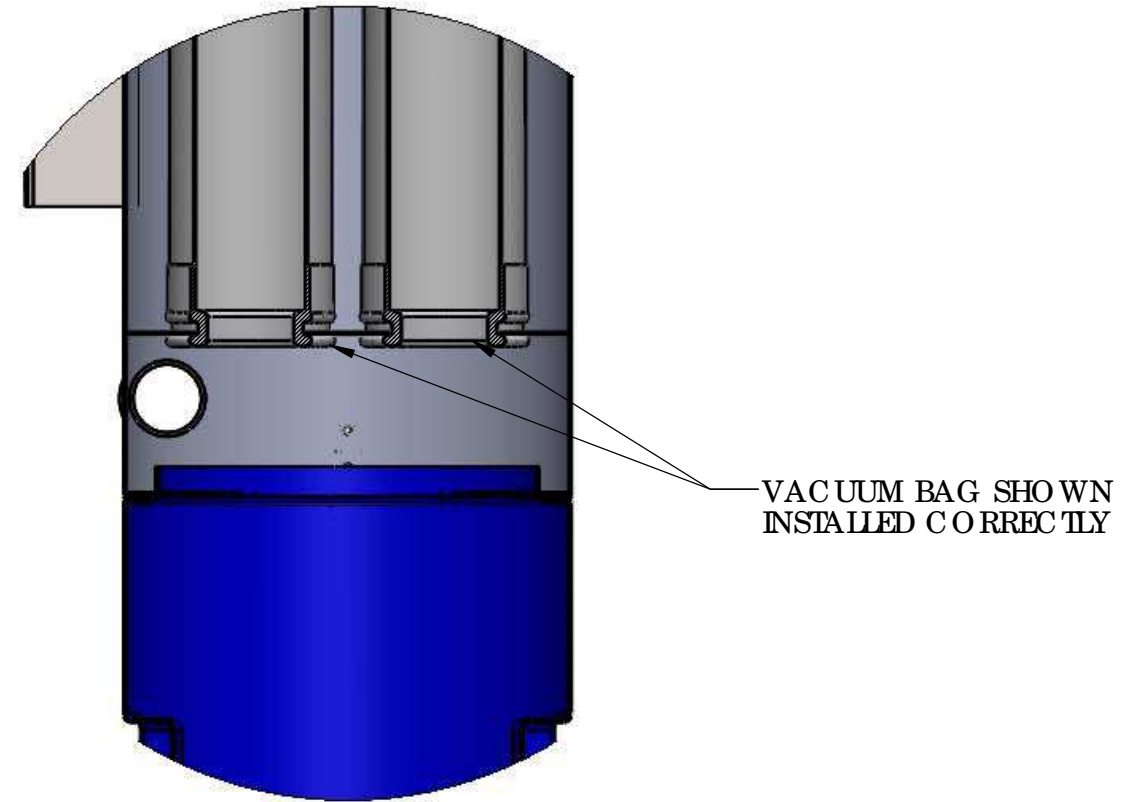

NOTES:
 1. UNLESS OTHERWISE SPECIFIED, ALL WIRE TO BE 16 AWG

*MICRO SWITCH OPTION:
 MOVE CONNECTION FROM
 TIMER TO TERMINAL BLOCK*

**TIMER SETTING
 INSTRUCTIONS**

	MIN. (SEC.)
	0.1 (6)
	0.2 (12)
	0.4 (24)
	0.8 (48)
	1.6 (96)
	3.2 (192)
	6.4 (384)

EXAMPLE AS SHOWN:
 1.2 MIN. (72 SEC.) PER COIN AND
 TWO COINS TO START FOR A
 TOTAL INITIAL RUN TIME OF 2.4
 MIN. (144 SEC.)

ADD, IN ON POSITION,
 FOR RUN TIME

ADD, IN ON POSITION,
 FOR NUMBER OF
 COINS TO START

